



# rtc<sup>®</sup>

QUICK CONNECT TECHNOLOGY  
[www.rtc-tec.com](http://www.rtc-tec.com)



# 127

rtc TYPE





**Standard version - Standardversion**

Nitrile (NBR)  
-10 °C +100 °C ( +14 °F +212 °F )

**Max. Working Pressure - Max. Betriebsdruck**

rtc 127.37 0 - 10 bar (0 - 145 PSI)

**Flow size - Nennweiten**

rtc 127.37 37 mm

**Options - Optionen**

Fluorocarbone - FPM (V)  
-10 °C +200 °C ( +14 °F +392 °F ) Ethylene Propylene  
EPDM: (E)  
-10 °C +180 °C ( +14 °F +356 °F )

**Material**

(Nickel Plated Brass - Messing vernickelt)

- |                                     |   |
|-------------------------------------|---|
| Coupler Body - Kupplungsgrundkörper | : Brass Nickel Plated -<br>Messing vernickelt |
| Sleeve - Hülse                      | : Steel - Stahl AISI 420                      |
| Valve - Ventil                      | : Stainless Steel - Edelstahl                 |
| Springs - Federn                    | : Stainless Steel - Edelstahl                 |
| Balls - Kugeln                      | : Stainless Steel - Edelstahl                 |
| Seals - Dichtungen                  | : Nitrile NBR (Ni)                            |
| Plug - Nippel                       | : Brass Nickel Plated -<br>Messing vernickelt |



Flow Rate vs Pressure Drop Graph / Durchflussrate vs Druckabfall

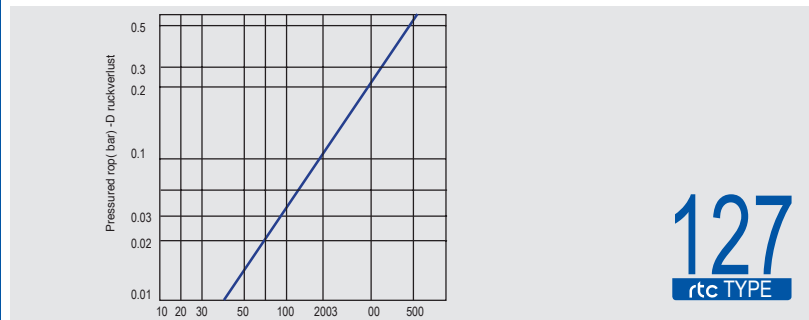

**127**  
rtc TYPE

rtc TYPE 127

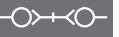

Socket / Kupplung

Size Größe	Connection (Ød)	Order No / Bestellnr.	Ød1 (mm)	L (mm)	HEX.
37	BSP 2	127.37 SFB 60	39	138	77
37	NPT 2	127.37 SNB 60	39	138	77
37	UNF 2-1/2-12	127.37 SUB 63	39	138	77

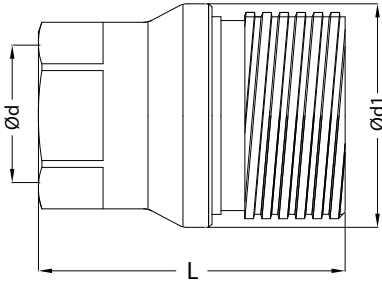

rtc TYPE 127



Plug / Nippel

Size Größe	Connection (Ød)	Order No / Bestellnr.	Ød1 (mm)	L (mm)	HEX.
37	BSP 2	127.37 PFB 60	39	138	77
37	NPT 2	127.37 PNB 60	39	138	77
37	UNF 2-1/2-12	127.37 PUB 63	39	138	77

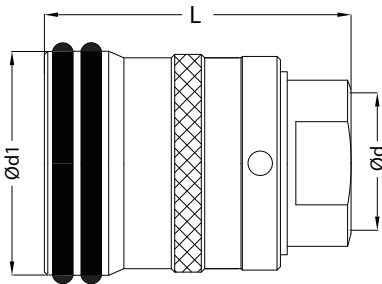

rtc TYPE 127

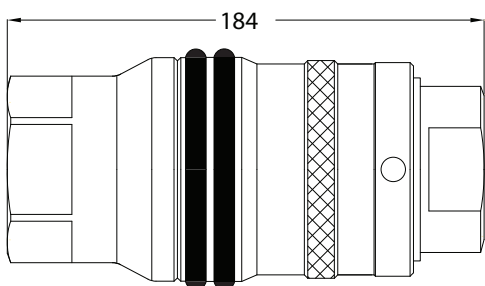

Size Größe	Brass Messing	Steel Stahl	Stainless Steel / Edelstahl (AISI 303 / AISI 316)
BSP 2	30 bar	95 bar	90 bar