

# rtc<sup>®</sup>

QUICK CONNECT TECHNOLOGY  
[www.rtc-tec.com](http://www.rtc-tec.com)



## 099

rtc TYPE

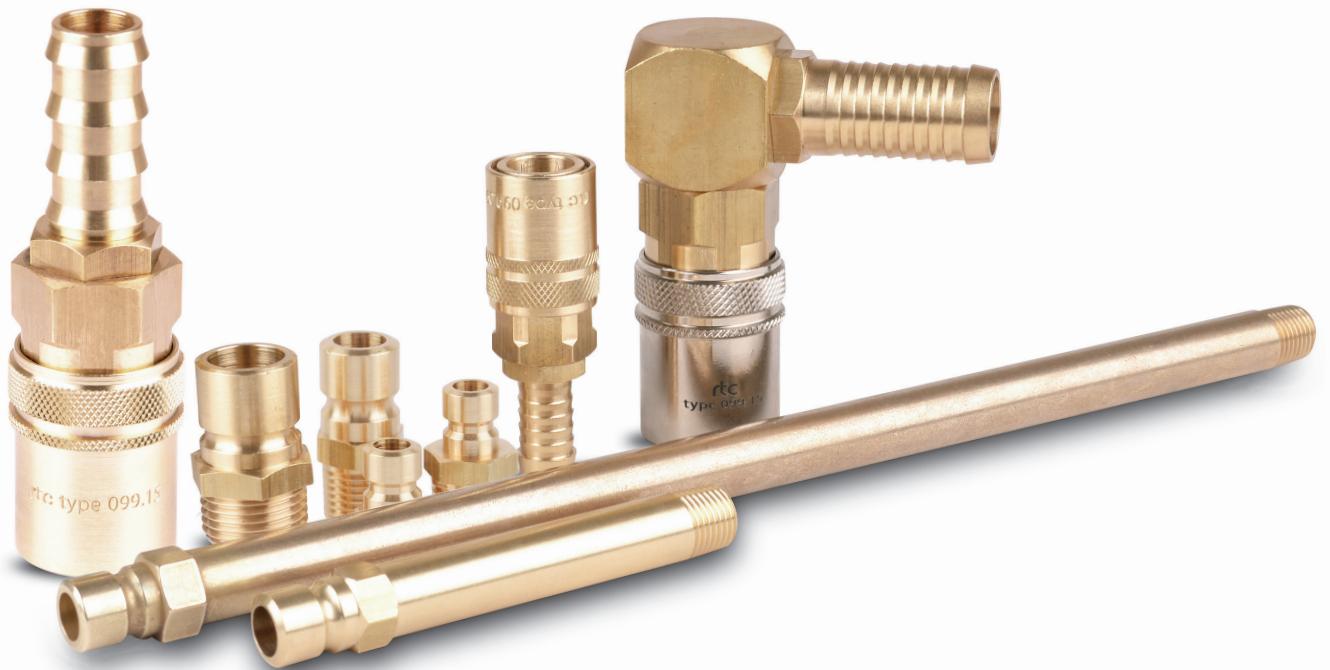



**International Profile**

Temperature Range - Temperaturbereich  
-5°C +180°C (+41°F +356°F) FPM (V)

**Working Pressure - Betriebsdruck**

rtc 099.06 0 - 10 bar (0 - 145 PSI)  
rtc 099.09 0 - 15 bar (0 - 217 PSI)  
rtc 099.15 0 - 15 bar (0 - 217 PSI)

**Flow size - Nennweiten**

rtc 099.06 6 mm  
rtc 099.09 9 mm  
rtc 099.15 15 mm

**Standard version - Standardversion**

Brass - Messing  
Seals FPM (V) - FPM dichtungen

**Material**

Coupler Body-  
Kupplungsgrundkörper Brass - Messing  
Sleeve - Hülse Brass - Messing  
Valve - Ventil Brass - Messing  
Springs - Federn Stainless steel - Edelstahl  
Locking O-Ring-  
Sprengring Stainless steel - Edelstahl  
Balls - Kugeln 18/8 Stainless steel - Edelstahl  
Seals - Dichtungen FPM (V)  
Plug - Nippel Brass - Messing

**Options - Optionen**

Stainless Steel - Edelstahl  
Safety lock - Sicherheitsentriegelung

**Using Area**

- On temperature regulation applications with hot or cold water, oil etc
- Injection moulding industries
- On steam line

**Anwendungsbereiche**

- Werkzeugtemperierung
- Kühlung mit Öl oder Wasser
- Kunststoffindustrie
- Dampfanwendungen

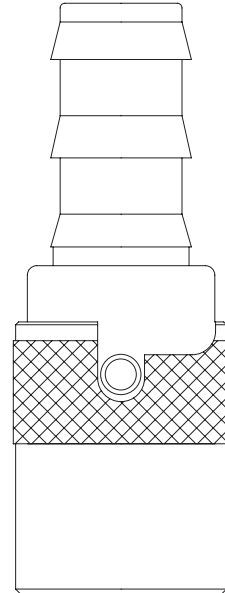

Safety type coupler for disconnect protection  
Sicherheitsfunktion für das ungewollte Trennen

Add "S" to item code / Fügen Sie "S" zur Artikelnummer hinzu

**Flow Rate vs Pressure Drop Graph**

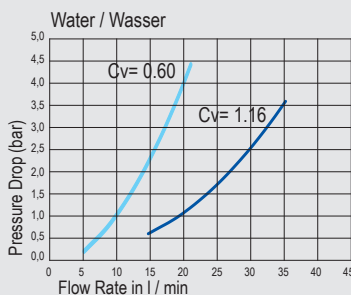

— 099.06 = Free passage 099.06 = Freier Durchgang  
— 099.06 = Shut-off 099.06 = Absperrend

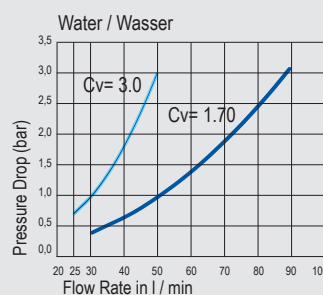

— 099.09 = Free passage 099.09 = Freier Durchgang  
— 099.09 = Shut-off 099.09 = Absperrend

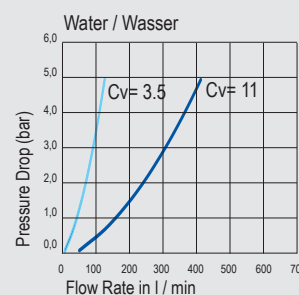

— 099.15 = Free passage 099.15 = Freier Durchgang  
— 099.15 = Shut-off 099.15 = Absperrend



rtc TYPE 099 Standard hose tail socket / Kupplung mit gerader Standard - Schlauchtülle



Sockets and Plugs

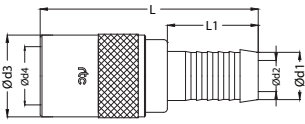

Size / Größe	Order No / Bestellnr. With Valve / Mit Ventil	Order No / Bestellnr. Without Valve / Ohne Ventil	D1	D2	D3	D4	L	L1
6	099.06 SHB 06	099.06 SHF 06	6	5	17	9.4	56	22.5
6	099.06 SHB 09	099.06 SHF 09	9	6	17	9.4	56	22.5
6	099.06 SHB 13	099.06 SHF 13	13	6	17	9.4	58	25
9	099.09 SHB 09	099.09 SHF 09	9	8	22	13.5	68	22.5
9	099.09 SHB 13	099.09 SHF 13	13	9	22	13.5	68	25
15	099.15 SHB 19	099.15 SHF 19	19	13	31	20	94	32

rtc TYPE 099 Push to connect hose tail socket / Kupplung mit gerader Schnellsteck - Schlauchtülle



Sockets / Kupplungen

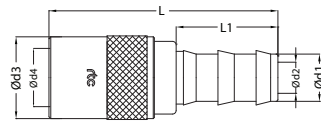

Size / Größe	Order No / Bestellnr. With Valve / Mit Ventil	Order No / Bestellnr. Without Valve / Ohne Ventil	D1	D2	D3	D4	L	L1
6	099.06 SPB 10	099.06 SPF 10	10	6	17	9.4	56	24
9	099.09 SPB 10	099.09 SPF 10	10	8	22	13.5	68	28
9	099.09 SPB 13	099.09 SPF 13	13	9	22	13.5	68	28
15	099.15 SPB 16	099.15 SPF 16	16	13	31	20	94	34
15	099.15 SPB 19	099.15 SPF 19	19	13	31	20	94	34

rtc TYPE 099 Standard hose tail socket 45° / Kupplung mit 45° Standard - Schlauchtülle



Sockets / Kupplungen

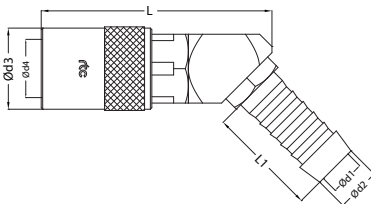

Size / Größe	Order No / Bestellnr. With Valve / Mit Ventil	Order No / Bestellnr. Without Valve / Ohne Ventil	D1	D2	D3	D4	L	L1
6	099.06 SHB 06 45	099.06 SHF 06 45	6	5	17	9.4	45	22.5
6	099.06 SHB 09 45	099.06 SHF 09 45	9	6	17	9.4	45	22.5
9	099.09 SHB 09 45	099.09 SHF 09 45	9	8	22	13.5	60	25
9	099.09 SHB 13 45	099.09 SHF 13 45	13	9	22	13.5	60	25
15	099.15 SHB 19 45	099.15 SHF 19 45	19	13	31	20	87	32

rtc TYPE 099 Push to connect hose tail socket 45° / Kupplung mit 45° Schnellsteck - Schlauchtülle



Sockets / Kupplungen

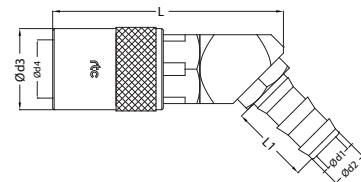

Size / Größe	Order No / Bestellnr. With Valve / Mit Ventil	Order No / Bestellnr. Without Valve / Ohne Ventil	D1	D2	D3	D4	L	L1
6	099.06 SPB 10 45	099.06 SPF 10 45	10	6	17	9.4	45	24
9	099.09 SPB 10 45	099.09 SPF 10 45	10	8	22	13.5	60	24
9	099.09 SPB 13 45	099.09 SPF 13 45	13	9	22	13.5	60	28
15	099.15 SPB 16 45	099.15 SPF 16 45	19	13	31	20	87	32



Standard hose tail socket 90° / Kupplung mit 90° Standard - Schlauchtülle

TYPE 099



Sockets / Kupplungen

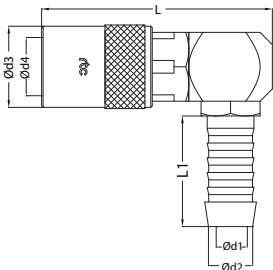

Size / Größe	Order No / Bestellnr. With Valve / Mit Ventil	Order No / Bestellnr. Without Valve / Ohne Ventil	D1	D2	D3	D4	L	L1
6	099.06 SHB 06 90	099.06 SHF 06 90	5	6	17	9.4	45	22.5
6	099.06 SHB 09 90	099.06 SHF 09 90	6	9	17	9.4	45	22.5
9	099.09 SHB 09 90	099.09 SHF 09 90	8	9	22	13.5	60	25
9	099.09 SHB 13 90	099.09 SHF 13 90	9	13	22	13.5	60	25
15	099.15 SHB 19 90	099.15 SHF 19 90	13	19	31	13.5	87	32



Push to connect hose tail socket 90° / Kupplung mit 90° Schnellsteck - Schlauchtülle

TYPE 099



Sockets / Kupplungen

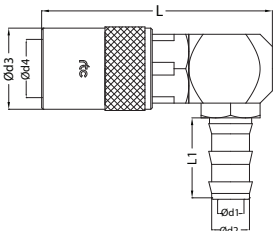

Size / Größe	Order No / Bestellnr. With Valve / Mit Ventil	Order No / Bestellnr. Without Valve / Ohne Ventil	D1	D2	D3	D4	L	L1
6	099.06 SPB 10 90	099.06 SPF 10 90	6	10	17	9.4	45	24
9	099.09 SPB 10 90	099.09 SPF 10 90	8	10	22	13.5	60	24
9	099.09 SPB 13 90	099.09 SPF 13 90	9	13	22	13.5	60	28
15	099.15 SPB 19 90	099.15 SPF 19 90	13	19	31	13.5	87	32



Cylindrical Male Thread socket / Kupplung mit Aussengewinde zylindrisch

TYPE 099



Sockets / Kupplungen

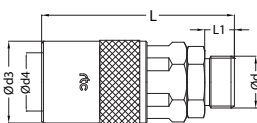

Size Größe	Order No / Bestellnr. With Valve / Mit Ventil	Order No / Bestellnr. Without Valve / Ohne Ventil	D	D3	D4	L	L1
6	099.06 SMB 13	099.06 SMF 13	BSP 1/4	17	9.4	48	9
6	099.06 SMB 17	099.06 SMF 17	BSP 3/8	17	9.4	48	9
6	099.06 SMB 1010	099.06 SMF 1010	M10x1	17	9.4	48	9
6	099.06 SMB 1415	099.06 SMF 1415	M14x1.5	17	9.4	48	9
6	099.06 SMB 1615	099.06 SMF 1615	M16x1.5	17	9.4	48	10
9	099.09 SMB 13	099.09 SMF 13	BSP 1/4	22	13.5	52	9
9	099.09 SMB 17	099.09 SMF 17	BSP 3/8	22	13.5	52	9
9	099.09 SMB 21	099.09 SMF 21	BSP 1/2	22	13.5	52	12
9	099.09 SMB 1615	099.09 SMF 1615	M16x1.5	22	13.5	52	10
15	099.15 SMB 21	099.15 SMF 21	BSP 1/2	31	20	74	12
15	099.15 SMB 26	099.15 SMF 26	BSP 3/4	31	20	78	16



Cylindrical Male Thread socket 45° / Kupplung mit 45° Aussengewinde zylindrisch

TYPE 099



Sockets / Kupplungen

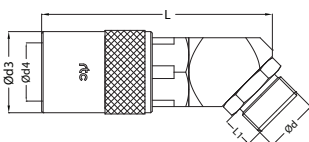

Size Größe	Order No / Bestellnr. With Valve / Mit Ventil	Order No / Bestellnr. Without Valve / Ohne Ventil	D	D3	D4	L	L1
6	099.06 SMB 10 45	099.06 SMF 10 45	BSP 1/8	17	9.4	45	7
6	099.06 SMB 13 45	099.06 SMF 13 45	BSP 1/4	17	9.4	45	9
6	099.06 SMB 1010 45	099.06 SMF 1010 45	M10x1	17	9.4	45	9
6	099.06 SMB 1415 45	099.06 SMF 1415 45	M14x1.5	17	9.4	45	9
9	099.09 SMB 17 45	099.09 SMF 17 45	BSP 3/8	22	13.5	60	9
9	099.09 SMB 1615 45	099.09 SMF 1615 45	M16x1.5	22	13.5	60	10
15	099.15 SMB 21 45	099.15 SMF 21 45	BSP 1/2	31	20	87	12

**rtc** TYPE 099 Cylindrical Male Thread socket 90° / Kupplung mit 90° Aussengewinde zylindrisch

Sockets / Kupplungen

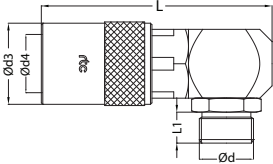

Size Größe	Order No / Bestellnr. With Valve / Mit Ventil	Order No / Bestellnr. Without Valve / Ohne Ventil	D	D3	D4	L	L1
6	099.06 SMB 10 90	099.06 SMF 10 90	BSP 1/8	17	9.4	47	7
6	099.06 SMB 13 90	099.06 SMF 13 90	BSP 1/4	17	9.4	47	9
6	099.06 SMB 1010 90	099.06 SMF 1010 90	M10x1	17	9.4	47	7
6	099.06 SMB 1415 90	099.06 SMF 1415 90	M14x1.5	17	9.4	47	9
9	099.09 SMB 17 90	099.09 SMF 17 90	BSP 3/8	22	13.5	54	9
9	099.09 SMB 1615 90	099.09 SMF 1615 90	M16x1.5	22	13.5	54	9
15	099.15 SMB 21 90	099.15 SMF 21 90	BSP 1/2	31	20	87	18

**rtc** TYPE 099 Cylindrical Female Thread socket / Kupplung innengewinde zylindrisch

Sockets / Kupplungen

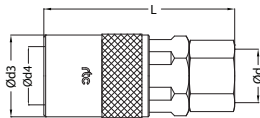

Size Größe	Order No / Bestellnr. With Valve / Mit Ventil	Order No / Bestellnr. Without Valve / Ohne Ventil	D	D3	D4	L	HEX.
6	099.06 SFB 10	099.06 SFF 10	BSP 1/8	17	9.4	40	17
6	099.06 SFB 13	099.06 SFF 13	BSP 1/4	17	9.4	42	17
6	099.06 SFB 17	099.06 SFF 17	BSP 3/8	17	9.4	42	21
6	099.06 SFB 1010	099.06 SFF 1010	M10x1	17	9.4	42	17
6	099.06 SFB 1415	099.06 SFF 1415	M14x1.5	17	9.4	42	17
9	099.09 SFB 13	099.09 SFF 13	BSP 1/4	22	13.5	52	22
9	099.09 SFB 17	099.09 SFF 17	BSP 3/8	22	13.5	52	22
9	099.09 SFB 21	099.09 SFF 21	BSP 1/2	22	13.5	55	22
15	099.15 SFB 21	099.15 SFF 21	BSP 1/2	31	20	75	33

**rtc** TYPE 099 Blank end socket / Blindkupplung

Sockets / Kupplungen

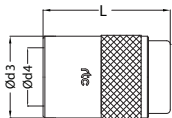

Order No / Bestellnr.	Body Size Größe	D3	D4	L
099.06 PL 00	6	17	9.4	27
099.09 PL 00	9	22	13.5	35
099.15 PL 00	15	31	20	58

**rtc** TYPE 099 Adapting socket with the plug / Adapterkupplung mit Nippel

Sockets and Plugs / Kupplung und Nippel

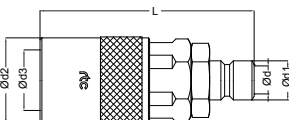

Order No / Bestellnr. With Valve / Mit Ventil	Order No / Bestellnr. Without Valve / Ohne Ventil	Plug Size Nippel Größe (D)	D1	D2	Socket Size Kupplung Größe (D3)	L	Passage
099.06 SXB 099.06	099.06 SXF 099.06	6	9.5	17	9.5	44.5	6
099.06 SXB 099.09	099.06 SXF 099.09	9	13.5	22	9.5	49.5	6
099.09 SXB 099.06	099.09 SXF 099.06	6	9.5	17	13.5	54.5	6
099.09 SXB 099.09	099.09 SXF 099.09	9	13.5	22	13.5	59.5	9

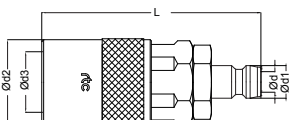

099.06 SXB 090.06	099.06 SXF 090.06	6	9	17	9.5	48	6
099.06 SXB 090.09	099.06 SXF 090.09	9	13	22	9.5	48	6
099.09 SXB 090.06	099.09 SXF 090.06	6	9	17	13.5	58	6
099.09 SXB 090.09	099.09 SXF 090.09	9	13	22	13.5	58	9



Diverting sockets / Umlenkklupplung

TYPE 099 **rtc**

Sockets / Kupplungen

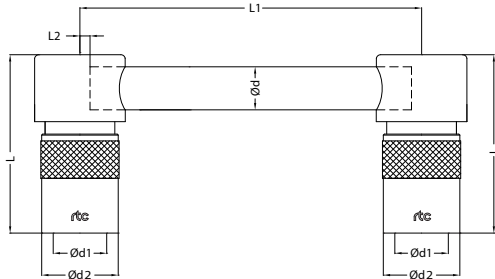

Size Größe	Order No / Bestellnr. Without Valve / Ohne Ventil	D	D1	D2	L	L1	L2
6	099.06 SCF 125	8x1	9.4	17	41	125	2
6	099.06 SCF 250	8x1	9.4	17	41	250	2
6	099.06 SCF 500	8x1	9.4	17	41	500	2
9	099.09 SCF 125	10x1	13.5	22	52.5	125	2
9	099.09 SCF 250	10x1	13.5	22	52.5	250	2
9	099.09 SCF 500	10x1	13.5	22	52.5	500	2

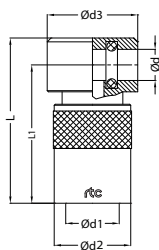

Size Größe	Order No / Bestellnr. Without Valve / Ohne Ventil	D	D1	D2	D3	L	L1
6	099.06 SCF 00	8x1	9.4	17	20	41	37
9	099.09 SCF 00	10x1	13.5	22	26	52.5	42

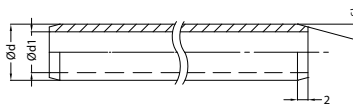

Pipe preparation / Verbindungsrohr

Brass Tube Messing Rohr	D	D1	Length Länge
TBM 0810x1000	8	6	1000mm
TBM 1010x1000	10	8	1000mm
TBM 1410x1000	14	12	1000mm



Adapting Plug 099 - 06 / Adapternippel 099 - 09

TYPE 099 **rtc**

Plugs / Nippel

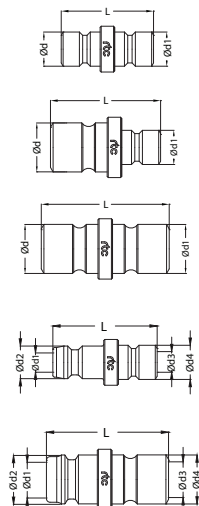

Order No / Bestellnr. With Valve / Mit Ventil	Body Size Größe	D	D1	L1
099.06 PXF 099.06	6	9.4	9.4	30
099.06 PXF 099.09	9	13.5	9.4	32
099.09 PXF 099.09	9	13.5	13.5	34
090.09 PXP 099.06	9	6	9.5	29
090.09 PXP 099.09	13	9	13.5	36

rtc TYPE 099

Stop Plug / Blindnippel



Plugs / Nippel

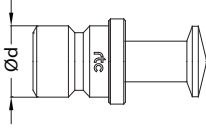

Order No / Bestellnr.	Body Size Größe	Ød
099.06 SL 00	6	9.4
099.09 SL 00	9	13.5
099.15 SL 00	15	20

rtc TYPE 099

Standard Hose Plug / Standard Schlauchtülle



Plugs / Nippel

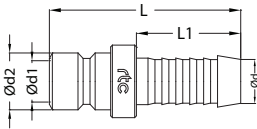

Order No / Bestellnr.	Body Size Größe	D	D1	D2	L	L1
099.06 PHF 06	6	6	5	9.4	37	22.5
099.06 PHF 09	6	9	6	9.4	37	22.5
099.09 PHF 09	9	9	7	13.5	45	22.5
099.09 PHF 13	9	13	9	13.5	45	25
099.15 PHF 16	15	16	10	20	57	32
099.15 PHF 19	15	19	13	20	57	32

rtc TYPE 099

Standard hose tail plug / Nippel mit gerader Standard - Schlauchtülle



Plugs / Nippel

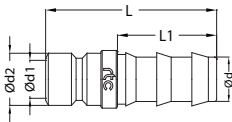

Order No / Bestellnr.	Body Size Größe	D	D1	D2	L	L1
099.06 PPF 06	6	6	5	9.4	43	24
099.06 PPF 10	6	9	6	9.4	43	24
099.09 PPF 10	9	9	7	13.5	49	24
099.09 PPF 13	9	13	9	13.5	49	28
099.15 PPF 16	15	16	10	20	67	38
099.15 PPF 19	15	19	13	20	67	38

rtc TYPE 099

Conical male thread plug / Nippel mit Aussengewinde konisch



Plugs / Nippel

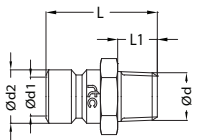

Order No / Bestellnr.		ØD	D1	D2	L	L1	HEX.
BSPT	NPT						
099.06 PRF 10	099.06 PTF 10	1/8	6	9.4	17	9	13
099.06 PRF 13	099.06 PTF 13	1/4	6	9.4	19	12	14
099.06 PRF 17	099.06 PTF 17	3/8	6	9.4	21	12	17
099.06 PKF 1010		M10x1	6	9.4	18	7	11
099.06 PKF 1415		M14x1.5	6	9.4	18	9	15
099.06 PKF 1615		M16x1.5	6	9.4	18	9	17

rtc TYPE 099

Conical male thread plug / Nippel mit Aussengewinde konisch



Plugs / Nippel

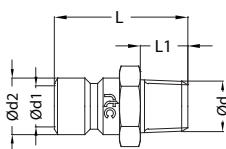

Order No / Bestellnr.		ØD	D1	D2	L	L1	HEX.
BSPT	NPT						
099.09 PRF 13	099.09 PTF 13	1/4	9	13.5	30	12	14
099.09 PRF 17	099.09 PTF 17	3/8	9	13.5	33	12	17
099.09 PRF 21	099.09 PTF 21	1/2	9	13.5	33	16	22
099.09 PKF 1010		M10x1	6.5	13.5	25	7	14
099.09 PKF 1415		M14x1.5	9	13.5	27	9	15
099.09 PKF 1615		M16x1.5	9	13.5	27	9	17



Conical male thread plug inner hex / Nippel mit Aussengewinde konisch mit Innensechskant

TYPE 099.06



Plugs / Nippel

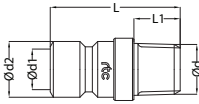

Order No / Bestellnr.	ØD	D1	D2	L	L1	HEX.
099.06 PRFH 10	BSPT 1/8	6	9.4	23	9	5
099.06 PRFH 13	BSPT 1/4	6	9.4	28	13	5
099.06 PKFH 1010	M10x1	6	9.4	23	9	5
099.06 PKHF 1415	M14x1.5	6	9.4	28	9	5



Conical male thread plug inner hex / Nippel mit Aussengewinde konisch mit Innensechskant

TYPE 099.09



Plugs / Nippel

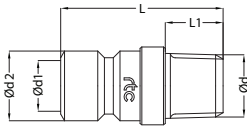

Order No / Bestellnr.	ØD	D1	D2	L	L1	HEX.
099.09 PRFH 13	BSPT 1/4	9	13.5	34	13	8
099.09 PRFH 17	BSPT 3/8	9	13.5	35	13	8
099.09 PRFH 21	BSPT 1/2	9	13.5	37	15	8
099.09 PKFH 1415	M14x1.5	9	13.5	30	9	8
099.09 PKFH 1615	M16 x1.5	9	13.5	31	9	8



Conical male thread plug with valve / Verschlussnippel mit Aussengewinde konisch

TYPE 099.06



Plugs / Nippel

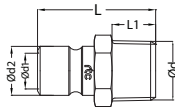

Order No / Bestellnr.		ØD	D1	D2	L	L1	HEX.
BSPT	NPT						
099.06 PRB 13	099.06 PTB 13	1/4	6	9.4	29	12	14
099.06 PRB 17	099.06 PTB 17	3/8	6	9.4	29	12	17
099.06 PKB 1415		M14x1.5	6	9.4	29	12	15



Conical male thread plug with valve / Verschlussnippel mit Aussengewinde konisch

TYPE 099.09



Plugs / Nippel

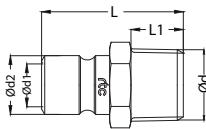

Order No / Bestellnr.		ØD	D1	D2	L	L1	HEX.
BSPT	NPT						
099.09 PRB 13	099.09 PTB 13	1/4	9	13.5	32.5	12	14
099.09 PRB 17	099.09 PTB 17	3/8	9	13.5	32.5	12	17
099.09 PRB 21	099.09 PTB 21	1/2	9	13.5	37	16	22
099.09 PKB 1415		M14x1.5	6	13.5	30	10	15
099.09 PKB 1615		M16x1.5	9	13.5	30	10	17



Conical male thread plug with valve / Verschlussnippel mit Aussengewinde konisch

TYPE 099.15



Plugs / Nippel

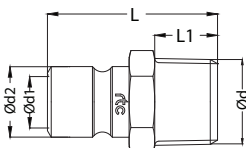

Order No / Bestellnr.		ØD	D1	D2	L	L1	HEX.
BSPT	NPT						
099.15 PRB 21	099.15 PTB 21	1/2	15	20	45.5	12	22
099.15 PRB 26	099.15 PTB 26	3/4	15	20	45.5	16	27



**rtc** TYPE 099.06

Plugs with female thread / Nippel mit Innengewinde



Plugs / Nippel

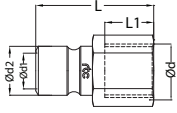

Order No / Bestellnr.	ØD	D1	D2	L	L1	HEX.
099.06 PFF 10	BSP 1/8	6	9.4	26	7	13
099.06 PFF 13	BSP 1/4	6	9.4	29	9	16
099.06 PFF 17	BSP 3/8	6	9.4	32	9	19

**rtc** TYPE 099.09

Plugs with female thread / Nippel mit Innengewinde



Plugs / Nippel

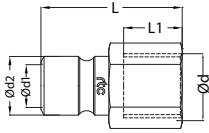

Order No / Bestellnr.	ØD	D1	D2	L	L1	HEX.
099.09 PFF 13	BSP 1/4	9	13.5	37	9	17
099.09 PFF 17	BSP 3/8	9	13.5	37	9	19
099.09 PFF 21	BSP 1/2	9	13.5	40	12	24

**rtc** TYPE 099.06

Conical male thread plug / Nippel mit Aussengewinde konisch



Plugs / Nippel

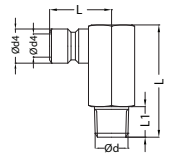

Order No / Bestellnr.		ØD	D1	D2	L	L1	L2	HEX.
BSPT	NPT							
099.06 PRF 10 90	099.06 PTF 10 90	1/8	6	9.4	27	9	23	11
099.06 PRF 13 90	099.06 PTF 13 90	1/4	6	9.4	34	11	23	15
099.06 PRF 17 90	099.06 PTF 17 90	3/8	6	9.4	34	9	23	11
099.06 PKF 1010 90		M10x1	6	9.4	27	11	23	11
099.06 PKF 1415 90		M14x1.5	6	9.4	34	11	23	15

**rtc** TYPE 099.09

Conical male thread plug / Nippel mit Aussengewinde konisch



Plugs / Nippel

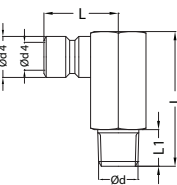

Order No / Bestellnr.		ØD	D1	D2	L	L1	L2	HEX.
BSPT	NPT							
099.09 PRF 13 90	099.09 PTF 13 90	1/4	9	13.5	34	11	24	15
099.09 PRF 17 90		3/8	9	13.5	34	11	24	17
099.09 PKF 1415 90		M14x1.5	9	13.5	34	11	24	17

**rtc** TYPE 099.06

Extention plug / Verlängerungsnippel ohne Gewinde



Plugs / Nippel

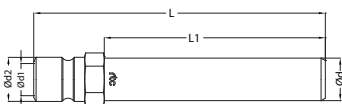

Order No / Bestellnr.	ØD	D1	D2	L	L1	HEX.
099.06 PEF 63	8	6	9.4	63	46	11
099.06 PEF 100	8	6	9.4	100	77	11
099.06 PEF 120	10	6	9.4	120	103	11
099.06 PEF 240	10	6	9.4	240	223	11
099.06 PEF 360	10	6	9.4	360	343	11



Male long thread plug / Nippel mit langem Aussengewinde

TYPE 099.06



Plugs / Nippel

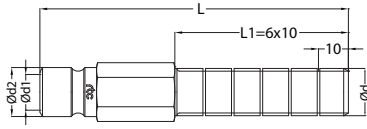

Order No / Bestellnr.

ØD

D1

D2

L

L1

HEX.

099.06 PMFL 10x60

BSP 1/8

6

9.4

100

6x10

11

099.06 PMFL 13x60

BSP 1/4

6

9.4

100

6x10

14

099.06 PMFL 17x60

BSP 3/8

6

9.4

100

6x10

17

099.06 PMFL 1010x60

M10x1

6

9.4

100

6x10

11

099.06 PMFL 1415x60

M14x1.5

6

9.4

100

6x10

14



Male long thread plug / Nippel mit langem Aussengewinde

TYPE 099.09



Plugs / Nippel

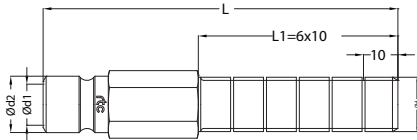

Order No / Bestellnr.

ØD

D1

D2

L

L1

HEX.

099.09 PMFL 13x60

BSP 1/4

9

13.5

100

6x10

14

099.09 PMFL 17x60

BSP 3/8

9

13.5

100

6x10

17

099.09 PMFL 1415x60

M14x1.5

9

13.5

100

6x10

14

099.09 PMFL 1615x60

M16x1.5

9

13.5

100

6x10

17



Steel extension tube with male thread zinc plated / Stahlrohr mit Aussengewinde verzinkt

TYPE 099



Plugs / Nippel

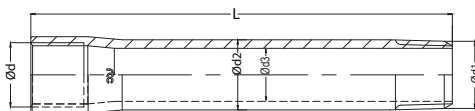

Order No / Bestellnr.  
BSPT NPT

ØD

D1

D2

D3

L

INNER  
HEX.

RGF 06-50

TNF 06-50

1/8

1/8

10

6

50

5

RGF 06-75

TNF 06-75

1/8

1/8

10

6

75

5

RGF 06-100

TNF 06-100

1/8

1/8

10

6

100

5

RGF 06-125

TNF 06-125

1/8

1/8

10

6

125

5

RGF 09-50

TNF 09-50

1/4

1/4

14

9

50

8

RGF 09-75

TNF 09-75

1/4

1/4

14

9

75

8

RGF 09-100

TNF 09-100

1/4

1/4

14

9

100

8

RGF 09-125

TNF 09-125

1/4

1/4

14

9

125

8

RGF 09-150

TNF 09-150

1/4

1/4

14

9

150

8

BSPT\* = BSP (Female) - BSPT (Male)  
NPT\* = NPT (Female) - NPT (Male)



Extention plug / Verlängerungsnippel ohne Gewinde

TYPE 099.09



Plugs / Nippel

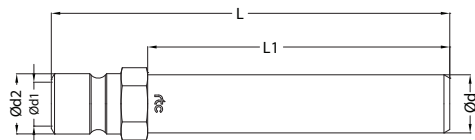

Order No / Bestellnr.

ØD

D1

D2

L

L1

HEX.

099.09 PEF 150

14

9

13.5

150

127

14

099.09 PEF 300

14

9

13.5

300

277

14

099.09 PEF 450

14

9

13.5

450

277

14

**rtc** TYPE 099

Extension plug / Verlängerungsniessel mit Aussengewinde



Plugs / Nippel

Order No / Bestellnr.  
BSPT NPT

ØD D1 D2 L L1 L2 HEX.

099.06 PRF 10xL	099.06 PTF 10xL	1/8	6	9.4	100	83	9	11
099.06 PKF 1010xL		M10x1	6	9.4	100	83	9	11
099.09 PRF 13xL		1/4	9	13.5	100	77	12	15
099.09 PKF 1415xL	099.09 PTF 13xL	M14x1/5	9	13.5	100	77	12	15
099.15 PRF 17xL	099.15 PTF 17xL	3/8	15	20	100	62	12	22
099.15 PRF 21xL	099.15 PTF 21xL	1/2	15	20	100	62	12	22

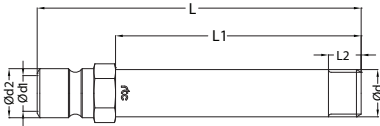

**rtc** TYPE 099.06

NPT Long threaded extension plug / Verlängerungsniessel mit langen NPT Aussengewinde



Plugs / Nippel

Order No / Bestellnr.  
NPT

ØD ØD1 ØD2 L

Order No / Bestellnr.  
NPT

ØD ØD1 ØD2 L

099.06 PTFS 10x63	1/8	6	9.4	63.5	099.06 PTFS 13x63	1/4	6	9.4	63.5
099.06 PTFS 10x101	1/8	6	9.4	101.6	099.06 PTFS 13x101	1/4	6	9.4	101.6
099.06 PTFS 10x140	1/8	6	9.4	140	099.06 PTFS 13x140	1/4	6	9.4	140
099.06 PTFS 10x178	1/8	6	9.4	178	099.06 PTFS 13x178	1/4	6	9.4	178
099.06 PTFS 10x216	1/8	6	9.4	216	099.06 PTFS 13x216	1/4	6	9.4	216
099.06 PTFS 10x254	1/8	6	9.4	254	099.06 PTFS 13x254	1/4	6	9.4	254
099.06 PTFS 10x292	1/8	6	9.4	292	099.06 PTFS 13x292	1/4	6	9.4	292
099.06 PTFS 10x330	1/8	6	9.4	330	099.06 PTFS 13x330	1/4	6	9.4	330

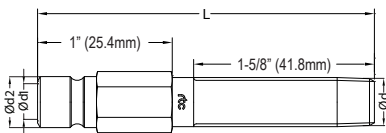

**rtc** TYPE 099.09

NPT Long threaded extension plug / Verlängerungsniessel mit langen NPT Aussengewinde



Plugs / Nippel

Order No / Bestellnr.  
NPT

ØD ØD1 ØD2 L

Order No / Bestellnr.  
NPT

ØD ØD1 ØD2 L

099.09 PTFS 13x63	1/4	9	13.5	63.5	099.09 PTFS 17x63	3/8	9	13.5	63.5
099.09 PTFS 13x101	1/4	9	13.5	101.6	099.09 PTFS 17x101	3/8	9	13.5	101.6
099.09 PTFS 13x140	1/4	9	13.5	140	099.09 PTFS 17x140	3/8	9	13.5	140
099.09 PTFS 13x178	1/4	9	13.5	178	099.09 PTFS 17x178	3/8	9	13.5	178
099.09 PTFS 13x216	1/4	9	13.5	216	099.09 PTFS 17x216	3/8	9	13.5	216
099.09 PTFS 13x254	1/4	9	13.5	254	099.09 PTFS 17x254	3/8	9	13.5	254
099.09 PTFS 13x292	1/4	9	13.5	292	099.09 PTFS 17x292	3/8	9	13.5	292
099.09 PTFS 13x330	1/4	9	13.5	330	099.09 PTFS 17x330	3/8	9	13.5	330

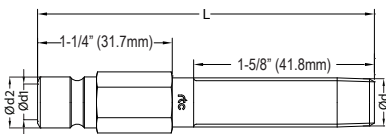

**rtc** TYPE 099.15

NPT Long threaded extension plug / Verlängerungsniessel mit langen NPT Aussengewinde



Plugs / Nippel

Order No / Bestellnr.  
NPT

ØD ØD1 ØD2 L

Order No / Bestellnr.  
NPT

ØD ØD1 ØD2 L

099.15 PTFS 17x63	3/8	15	20	63.5	099.15 PTFS 21x63	1/2	15	20	63.5
099.15 PTFS 17x101	3/8	15	20	101.6	099.15 PTFS 21x101	1/2	15	20	101.6
099.15 PTFS 17x140	3/8	15	20	140	099.15 PTFS 21x140	1/2	15	20	140
099.15 PTFS 17x178	3/8	15	20	178	099.15 PTFS 21x178	1/2	15	20	178
099.15 PTFS 17x216	3/8	15	20	216	099.15 PTFS 21x216	1/2	15	20	216
099.15 PTFS 17x254	3/8	15	20	254	099.15 PTFS 21x254	1/2	15	20	254
099.15 PTFS 17x292	3/8	15	20	292	099.15 PTFS 21x292	1/2	15	20	292
099.15 PTFS 17x330	3/8	15	20	330	099.15 PTFS 21x330	1/2	15	20	330

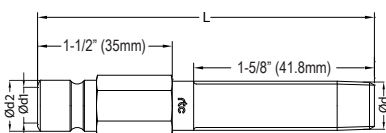



Steel extension tube with male thread / Stahlrohr mit Aussengewinde

TYPE 099 **rtc**

Plugs / Nippel

Order No / Bestellnr.

BSPT

NPT

ØD

D1

D2

L

RRF 06-50	TTF 06-50	1/8	10	6	50
RRF 06-100	TTF 06-100	1/8	10	6	100
RRF 06-150	TTF 06-150	1/8	10	6	150
RRF 06-200	TTF 06-200	1/8	10	6	200
RRF 06-250	TTF 06-250	1/8	10	6	250

RRF 09-50	TTF 09-50	1/4	14	9	50
RRF 09-100	TTF 09-100	1/4	14	9	100
RRF 09-150	TTF 09-150	1/4	14	9	150
RRF 09-200	TTF 09-200	1/4	14	9	200
RRF 09-250	TTF 09-250	1/4	14	9	250

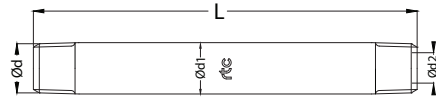

RRF 12-50	TTF 12-50	3/8	17	13	50
RRF 12-100	TTF 12-100	3/8	17	13	100
RRF 12-150	TTF 12-150	3/8	17	13	150
RRF 12-200	TTF 12-200	3/8	17	13	200
RRF 12-250	TTF 12-250	3/8	17	13	250

RRF 15-100	TTF 15-100	1/2	22	16	100
RRF 15-150	TTF 15-150	1/2	22	16	150
RRF 15-200	TTF 15-200	1/2	22	16	200
RRF 15-250	TTF 15-250	1/2	22	16	250



Replacement seal / Ersatz O-Ring

TYPE 099 **rtc**

Replacement Seals

Order No / Bestellnr.

Type

Material

Working Temp.



SS 099.06 N	6	NBR	-10°C - 100°C
SS 099.09 N	9	NBR	-10°C - 100°C
SS 099.15 N	15	NBR	-10°C - 100°C
SS 099.06 V	6	FKM	-5°C - 200°C
SS 099.09 V	9	FKM	-5°C - 200°C
SS 099.15 V	15	FKM	-5°C - 200°C