



# rtc<sup>®</sup>

COUPLING TECHNOLOGY



## 072

rtc TYPE



**Compatible - Kompatibilität**  
ISO 16028

**Temperature Range - Temperaturbereich**  
-20°C +100°C (-4°F +212°F) Nitril (N)  
-10°C +180°C (+14°F +356°F) FPM (V)

**Max. Working Pressure - Max. Betriebsdruck**

rtc 072.05	400 bar (5800 PSI)
rtc 072.06	400 bar (5800 PSI)
rtc 072.10	375 bar (5450 PSI)
rtc 072.12	350 bar (3625 PSI)
rtc 072.16	350 bar (5075 PSI)
rtc 072.19	300 bar (4350 PSI)
rtc 072.25	250 bar (4350 PSI)

**Flow size - Nennweiten**

rtc 072.05	5 mm
rtc 072.06	6 mm
rtc 072.10	10 mm
rtc 072.12	12 mm
rtc 072.16	16 mm
rtc 072.19	19 mm
rtc 072.25	25 mm

**Material**

Socket Body- Kupplungsgrundkörper	Steel zinc plated - Stahl verzinkt
Sleeve - Hülse	Steel zinc plated - Stahl verzinkt
Valve - Ventil	Steel zinc plated - Stahl verzinkt
Springs - Federn	Stainless steel - Edelstahl
Seal - Dichtung	Nitrile (N)
Balls - Kugeln	Stainless steel - Edelstahl

Plug - Nippel                      Steel zinc plated - Stahl verzinkt

**Using Area**

- The system perfectly fits to the ISO 16028 requirements.
- On hydraulic oil circuits
- Hydraulic test units
- Injection moulding industries / core pullers

**Anwendungsbereiche**

- Anforderungen von ISO 16028
- Hydraulische Verbindungen
- Hydraulik Prüfstände
- Kunststoffindustrie / Kernzüge



Flow Rate vs Pressure Drop Graph / Durchflussrate vs Druckabfall

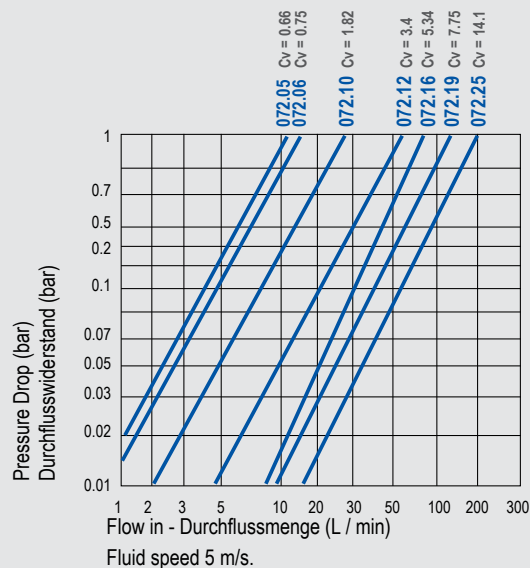

**072**  
rtc TYPE

rtc TYPE 072 ISO 16028

Female thread socket / Kupplung mit Innengewinde

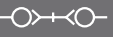

Socket / Kupplung

Size / Größe

Order No / Bestellnr.

Ød

Ød1

L

HEX.

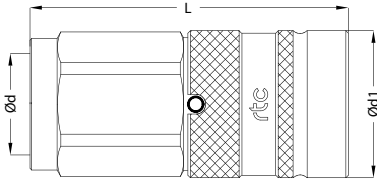

05

072.05 SFB 10  
072.05 SNB 10

BSP 1/8  
NPT 1/8

20  
20

40  
40

19  
19

06

072.06 SFB 13  
072.06 SNB 13

BSP 1/4  
NPT 1/4

28  
28

58  
58

27  
27

10

072.10 SFB 17  
072.10 SNB 17  
072.10 SFB 21  
072.10 SNB 21

BSP 3/8  
NPT 3/8  
BSP 1/2  
NPT 1/2

32  
32  
32  
32

69  
69  
74  
74

30  
30  
30  
30

12

072.12 SFB 21  
072.12 SNB 21

BSP 1/2  
NPT 1/2

38  
38

84  
84

36  
36

16

072.16 SFB 26  
072.16 SNB 26

BSP 3/4  
NPT 3/4

42  
42

84  
84

41  
41

19

072.19 SFB 33  
072.19 SNB 33

BSP 1  
NPT 1

46  
46

99  
99

46  
46

25

072.25 SFB 33  
072.25 SNB 33

BSP 1  
NPT 1

55  
55

118  
118

55  
55

rtc TYPE 072 ISO 16028

Female thread plug / Nippel mit Innengewinde



Plugs / Nippel

Size / Größe

Order No / Bestellnr.

Ød

Ød1

L

HEX.

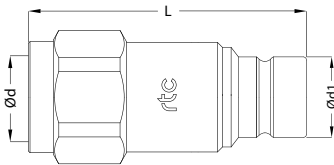

05

072.05 PFB 10  
072.05 PNB 10

BSP 1/8  
NPT 1/8

11.5  
11.5

35  
35

17  
17

06

072.06 PFB 13  
072.06 PNB 13

BSP 1/4  
NPT 1/4

16  
16

54  
54

22  
22

10

072.10 PFB 17  
072.10 PNB 17  
072.10 PFB 21  
072.10 PNB 21

BSP 3/8  
NPT 3/8  
BSP 1/2  
NPT 1/2

20  
20  
20  
20

60  
60  
63  
63

27  
27  
27  
27

12

072.12 PFB 21  
072.12 PNB 21

BSP 1/2  
NPT 1/2

24.5  
24.5

71  
71

36  
36

16

072.16 PFB 26  
072.16 PNB 26

BSP 3/4  
NPT 3/4

27  
27

73  
73

36  
36

19

072.19 PFB 33  
072.19 PNB 33

BSP 1  
NPT 1

30  
30

85  
85

46  
46

25

072.25 PFB 33  
072.25 PNB 33

BSP 1  
NPT 1

36  
36

90  
90

50  
50